

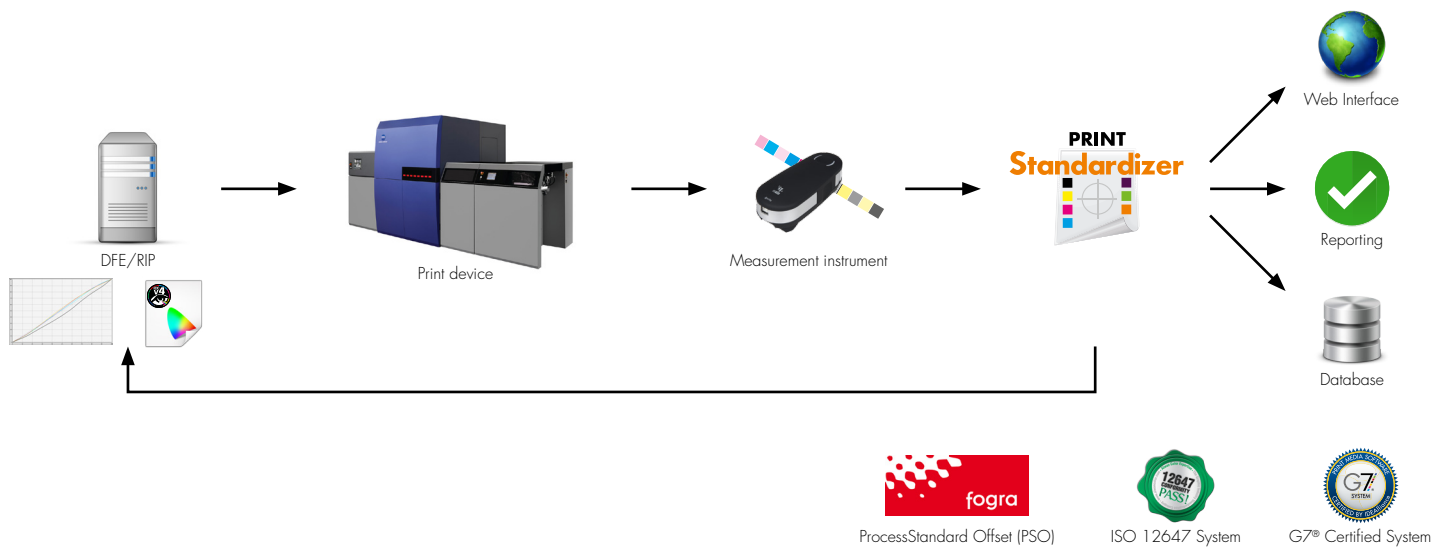

## Alwan PrintStandardizer

Print stable and consistent colors on any printing process.



## Main benefits

### Print device stability

- Predictable colors
- Repeatable colors
- Faster make-readies

### Device-to-device consistency

- Shared appearance across devices
- One solution for all processes
- Digital, offset, flexo and gravure

### ISO/G7<sup>®</sup> certified production

- Conform to ISO 12647
- Conform to G7<sup>®</sup>
- Certification reports

## Alwan PrintStandardizer (APS/X) is more than a process control server!

It is made for print device calibration and profiling no matter what printing process and how many devices you use. Simply print stable and consistent colors with any conventional or digital print device thanks to the Alwan PrintStandardizer solution.

**Alwan PrintStandardizer is a unique process control server with exclusive technologies that allows you to print stable and consistent colors conform to standards.**

## Automated device calibration

Connect APS/X to your measurement instrument<sup>1</sup> or to your ink closed-loop system and let it do the rest. During production, APS/X automatically collects, filters, qualifies and averages measurement data to accurately modelize and adjust print device tone reproduction curves. Printers can therefore accurately calibrate their conventional or digital print device without tedious printing sessions or interruption of production.

<sup>1</sup> For supported measurement instruments, please read our "Alwan PrintStandardizer - Technical Data" brochure.

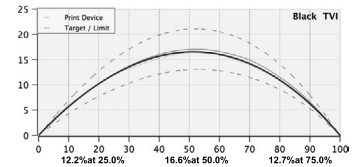

## Automated device Profiling with Hydra Profiling<sup>®</sup> option<sup>2</sup>



When Hydra Profiling<sup>®</sup> option is activated, process control strip measurements are used to accurately modelize and profile print device gamut. Alwan Hydra Profiling<sup>®</sup> patent pending spectral technology is able to generate accurate ICC profiles from only 40 patches for CMYK devices and 96 patches for 7c devices. Printers can therefore accurately profile their conventional or digital print devices without tedious printing sessions or interruption of production.

<sup>2</sup> For more details, please read our "Hydra Profiling<sup>®</sup>: Spectral Profiling by Alwan" brochure.

## Accurate colors thanks to prepress-to-press closed-loop

Accurate proof-to-press match and device-to-device match can be achieved when up-to-date device curves and ICC profiles are applied in prepress. The best way to do that is to use Alwan's process control server – Alwan PrintStandardizer – in conjunction with Alwan's color management server – Alwan ColorHub<sup>3</sup> (ACH). The two pieces of software combined will automatically ensure stable, consistent and accurate colors for every job without any human intervention.

<sup>3</sup> For more details, please read our "Alwan ColorHub" and "Digital Closed-Loop by Alwan" brochures.



## High Fidelity (HiFi) and Extended Color Gamut (ECG) printing option<sup>4</sup>

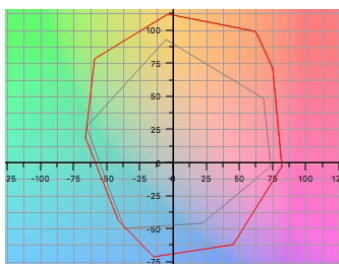

Because Extended Color Gamut printing is a special process using additional inks such as orange, green and violet inks, it is of paramount importance to:

1. Calibrate and linearize all primary and secondary ink channels to maximize color gamut;
  2. Profile print device; and
  3. Maintain these printing conditions during production.
- This is exactly what APS/X does and, in conjunction with Alwan ColorHub HiFi option, ECG process curves and ICC profile are automatically built, updated and applied in prepress, making visuals more colorful and brand colors simulation more accurate than ever before.

<sup>4</sup> For more details, please read our "HiFi/Extended Color Gamut by Alwan" brochure.

## ISO 12647 and G7<sup>®</sup> certified system



APS/X is the first process control system to receive ISO 12647 and G7<sup>®</sup> certifications shortly after its release in 2008. This is a guarantee that any sheet and job that passes APS/X assessment will pass any customer or third-party audit. Alwan PrintStandardizer even allows you to go the extra mile by setting your own standard or your own custom scoring system for your sheet and job assessments.

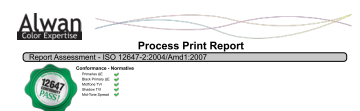

You need more information or you are interested in trying Alwan PrintStandardizer?  
Please contact your local dealer or email us at [info@alwancolor.com](mailto:info@alwancolor.com)



[www.alwancolor.com](http://www.alwancolor.com)